

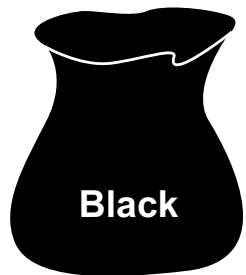

## Non-Infectious Waste

- Paper/Packaging material
- Food



## Infectious Waste

- Gauze/Dressing
- Blood/IV fluid lines
- Gloves

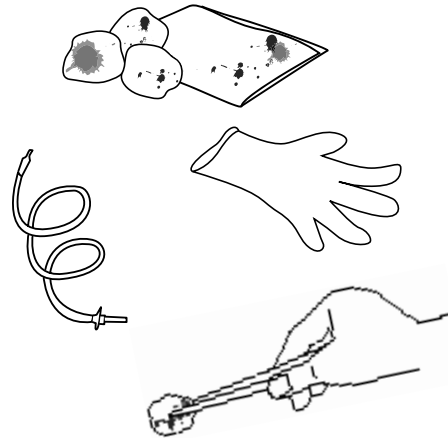

## Highly Infectious Waste

- Anatomical waste
  - Teeth
  - Placenta
- Pathological waste
  - Sputum container
  - Test tubes containing specimens

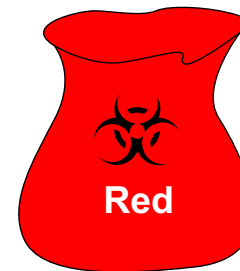
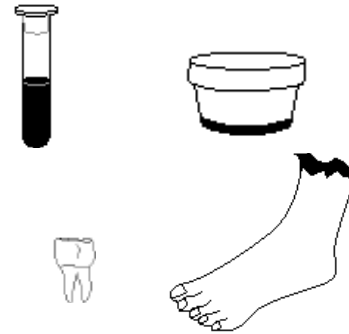

## Sharps Waste

- Infusion sets
- Broken slides
- Broken vial
- Broken ampules
- Lancet
- Retractable
- Scalpels
- Blades
- Needles

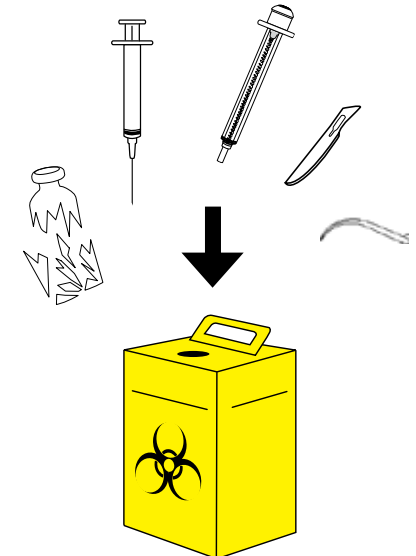

If using a  
needle  
remover

